

# AUTUMN STAR STOCK CHASSIS CABS IN RSA

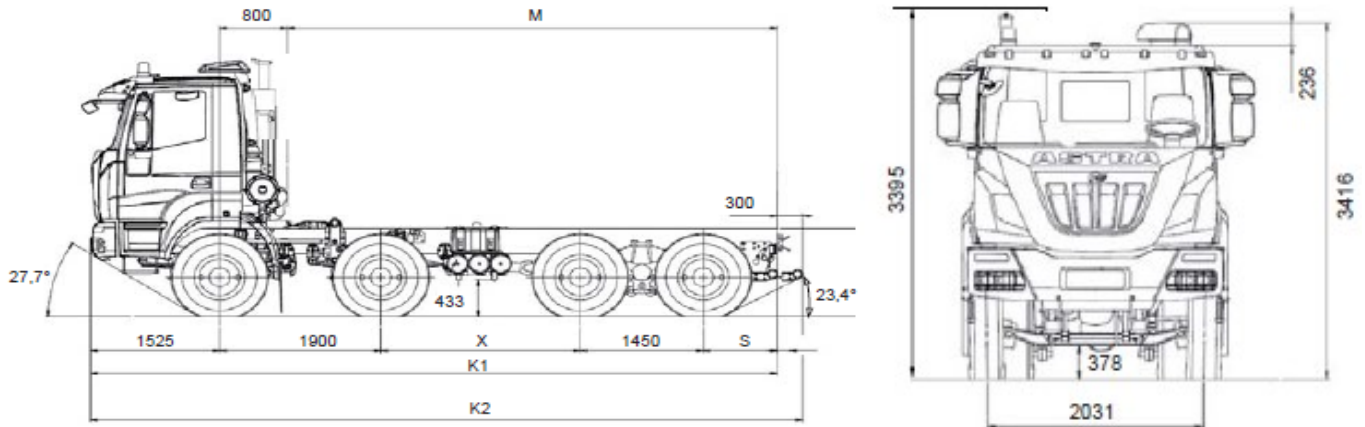

**EURO 3**

**HD9**  
chassis 8x4



## Standard Specs

- MODEL: ASTRA HD9 84.44
- DRIVE:- RIGHT HAND-RHD
- DIMENSION: - X = 2350 mm, S = 1200 mm
- COLOUR: - STANDARD WHITE
- TRANSMISSION: MANUAL, ZF 16 SPEEDS, 2220 TO



## Optional Specs Included

- AIR CONDITIONER WITH 20 MICRON POLLEN FILTER
- EXTERNAL SUN VISOR
- SEPERATOR FILTER: VULKAN CATRIDGE TYPE
- EJECTTOR DONALDSON
- RADIO: FITTED
- ROTATING ORANGE LIGHTS
- PTO: MULTIPOWER POWER FLYWHEEL MOUNTED
- REAR WINDOW IN CAB
- PNUEMATIC PASSENGER SEAT
- REAR MANUOVERING HOOK
- TYRES; 13R22.5, SINGLES FRONT, DUAL REAR, + 1 X SPARE